

EI Cores

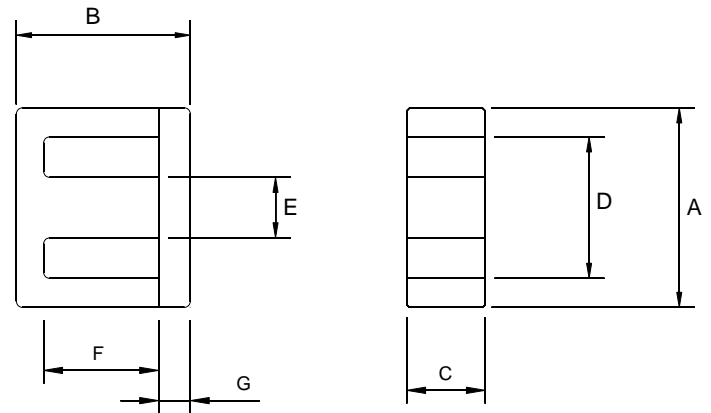

Application of EI cores
 Transformers for SMPS
 Impedance matching Transformers
 Miniature and SMD transformers



DIMENSIONS

Type	A(mm)	B(mm)	C(mm)	D(mm)	E (mm)	F (mm)	G(mm)
EI1614	16 ± 0.3	14.5 ± 0.5	4.8 + 0.1 - 0.2	11.7 Min	3.8 ± 0.2	10.4 ± 0.2	2 ± 0.2
EI1916	19.2 ± 0.4	15.2 + 0.8 - 0.4	5.50 + 0.01 - 0.2	14 Min	5.1 +0/-0.50	10.5 ± 0.3	2.4 ± 0.2
EI2218	22.00 ± 0.6	19 ± 0.5	6.00 + 0.00 - 0.50	15.6 Min	6.1 +0/-0.50	11 ± 0.3	4.00 ± 0.3
EI2519	25.00 + 0.50 - 0.30	19.30 + 0.70 - 0.30	6.50 ± 0.30	17.80 Min	6.50 ± 0.25	13.00 + 0.40 - 0.00	3.30 ± 0.30
EI2820	28.00 ± 0.50	20.20 + 0.30 - 0.80	11.00 + 0.00 - 0.60	18.60 Min	7.50 + 0.00 - 0.60	12.20 + 0.50 - 0.00	3.50 ± 0.30
EI2820 A	28.00 ± 0.50	20.80 ± 0.60	11.00 + 0.20 - 0.30	18.60 Min	7.50 + 0.00 - 0.60	12.80 ± 0.30	3.50 ± 0.30
EI3026	30.00 + 0.70 - 0.20	26.50 + 0.60 - 0.00	11.00 + 0.0 - 0.70	20.00 + 0.70 - 0.00	11.00 + 0.00 - 0.70	16.00 + 0.60 - 0.00	5.50 ± 0.20
EI3329	33.00 ± 0.50	28.75 ± 0.50	13.00 + 0.00 - 0.60	23.40 Min	10.00 + 0.00 - 0.60	19.00 + 0.50 - 0.00	5.00 ± 0.30
EI3530	35.00 + 0.80 - 0.50	29.60 + 0.90 - 0.20	12.00 + 0.00 - 0.60	25.30 Min	10.30 + 0.00 - 0.60	18.30 + 0.60 - 0.00	5.50 ± 0.20
EI4035	40.00 ± 0.50	35.00 + 0.80 - 0.30	12.00 + 0.00 - 0.70	27.50 + 0.70 - 0.00	12.00 + 0.00 - 0.70	20.20 + 0.50 - 0.00	7.50 ± 0.30
EI5042	50.10 ± 1.00	42.05 + 0.75 - 0.25	14.70 ± 0.40	34.50 + 0.70 - 0.00	14.60 ± 0.40	24.50 + 1.00 - 0.00	9.00 ± 0.25
EI7026	70.00 ± 1.50	56.00 ± 1.00	19.50 ± 0.50	50.00 ± 0.50	19.50 ± 0.50	35.50 ± 0.50	10.50 ± 0.50



EFFECTIVE PARAMETERS

Type	Wt set Gm	Le mm	Ae mm ²	Ve mm ³	AL± 25%	
					MSB7C	MSB5S
EI1614	3.70	35.3	190	660	385	400
EI1916	4.7	38.16	25.5	976	600	670
EI2218	8	41	36	1476	1600	1600
EI2519	10.20	47.1	42.0	1980	2100	2500
EI2820	22.00	48.9	86.0	4140	5000	
EI2820 A	23.00	49.5	86.5	4195		6500 min InMGQ5C
EI3026	34.00	58.6	110.0	6440	4000	3900
EI3329	42.00	67.5	119.0	8040	3700	5200
EI3530	41.50	67.3	120.0	8076	4000	4800
EI4035	60.30	77.1	147.0	11370	4500	5400
EI5042	110.90	95.4	226.4	21599	1500	1500
EI7026	257.40	133.0	390.0	51870	1500	2010

AL Values : nH ±25% 1KHz 0.1V 100Ts